

PRELIMINARY APPLICATION FORM

1. IDENTIFICATION AND ADDRESS NOTICE

1.1 Identification of applicant company	
Name : FCNQ Construction	
Civic Address : 19400 Clark-Graham, Baie D'Urfé, Québec, H9X3R8	
Address (if different form civic address) :	
Name and fonction of the authorized signatory (s) to present the request: Eric Lewin, General Manager	
Telephone number : 514 457 - 9371	Telephone number (other) : -
E-mail address : Eric.Lewin@fcnq.ca	
1.2 Company registration n°	
Company number of Québec (NEQ) : 1164824410	
1.3 Municipality resolution	
Appendix I	
1.4 Identification of consultant mandated promoter (if applicable)	
Name :	
Civic Address :	
Address (if different form civic address):	
Telephone number : -	Telephone number (other) : -
E-mail address : @	
Description of the mandate :	

2. LOCALISATION AND IMPLEMENTATION SCHEDULE OF THE PROJECT

2.1 Identification and location of the project and activities	
Name of the municipality, village, or town of the location of the proposed project Puvirnitug	
Categories of land (I, II ou III) : III	
Géographic coordinates in decimal degrees of central point of project: Central point or start of project : Latitude : 60.036325 Longitude : -77.363761 Final point of project (if applicable) : Latitude : Longitude :	
2.2 Description of proposed site by the project	
Describe the main components of physical, biology and human environment to be affected by the project The site is located more than 2 km of any human's activity or habitations	

2.3 Implementation schedule

Provide the implementation schedule with the time required to the impact statement and the procedure progress

Start date June 2020
Projected completion date June 2022

- Construction and development of access road, 2 weeks
 - Removal organic soil (if applicable), 1 week
 - Survey works throughout the project duration
 - Drilling works throughout the project duration
 - Loading of holes throughout the project duration
 - Blasting throughout the project duration (every 5 days)
 - Crushing and sieving throughout the project duration
 - Stockpiling throughout the project duration

2.4 Location plan

Add in appendix III a topographic map of the project.

3. GENERALE PRESENTATION OF THE PROJET

3.1 Title of project

Project of Aggregate productions for the CO-OP of Puvirnitug

3.2 Subjugation

In order to verify the subjugation of the project, indicate what paragraph of the appendix A in Quebec Environment quality act your project is subjugate.

The project is a new quarry. It should be subjugated by Appendix A, paragraph b) but the surface is less than 3 Hectares.

3.3 Summary description of the project

The project is composed of two phases, main exploitation and rehabilitation of the new quarry. During the main exploitation phase, the main works are:

- Construction and development access road,
 - Removal organic soil (if applicable),
 - Survey works
 - Drilling works
 - Loading of holes
 - Blasting throughout
 - Crushing and sieving
 - Stockpiling

All task will be executed by qualified staff with equipment and machinery properly maintained and perfect condition

When exploitation phase is completed, a rehabilitation process will be put in action:

- Boulders will be deposited and stockpiled in specified storage areas.
As a precaution measure, few boulders will be used to stabilize the site components on direct access.
- If unstable boulders are noticed, its will be removed safely and stored in the designated area
- If necessary, security fence of 1.22m will be installed.
- If side walls are 10m of high or more, intermediate levels of 4m will be done
- The quarry floor will be restored in order to insure adequate water drainage, control sedimentation ect.

Add in appendix II all documents for the purpose project

3.4 Objectives and project justification

Describe the main objectives and the reasons of this project:

FCNQ Construction Inc., affiliate of the Fédération des cooperatives du Nouveau-Québec, answered to the needs constructions of the North and was devoted for the sustainable development since forty years.

As one of the few 100% Inuit-owned construction companies, the CO-OP of Puvimituq asked us to produce 200,000 tons of aggregates, different gradations will be produced in order to better support local constructor needs

Thanks to the project, the local community will benefit self-sufficiency of aggregates for estimated ten years.

3.5 Incidental activities

Summarized the incidental activities and all other project susceptible to impact the proposal project.

To provide access to the location, a road will be built between publics road and the site. (Appendix II)

4 PUBLIC INFORMATION AND CONSULTATION

4.1 Public information process

Appendix I : municipality resolution

5 DESCRIPTION OF MAIN ISSUES AND IMPACT APPREHENDED OF THE PROJECT ON THE RECEIVING ENVIRONMENT

5.1 Description of the key issues of project

Describe briefly the key issues of the project:

The location of the new quarry was never used before for this purpose. The soil is not disturbed by any previous operation.

Being away of any local activities and homes (>1200m), noise is not a constraint to the local population. The potential constraints as well as solutions:

- Special weather conditions, strong wind (> 100 km/h): The work will be stopped temporary if there is a risk on employee and/or local people.
- Accidental spill of oil product: No wasted would be stored at the site, but in case of spill an emergency process will be done.
- Discovery of local fauna during the work: Immediate stop of work. Necessary measures will be taken by professionals
- Discovery of artifacts or other items of cultural or historical value: Immediate stop of work
- Discovery of soapstone or other material of value: Immediate stop of work
- Soil erosion risk: Before start of work, measures will be taken to remove any soil erosion risk

5.2 Description of main impact apprehended of the project on the receiving environment

Describe briefly the impact apprehended

Impact on site will be minimal since there is no human activity less than 1.2km. If necessary, measures and activities will be put in effect to minimize any potential impact. Once on site work done, a rehabilitation process will start

6. GREENHOUSES GAS EMISSIONS

6.1 Greenhouses gas emissions

Describe if the project will be issued greenhouses gas emissions

The construction vehicles are the main sources of projected emission.

7. ADDITIONAL DETAILS

7.1 Additional details

8. DECLARATION AND SIGNATURE

8.1 Déclaration and signature
<i>I certify that the document and the information provided in this preliminary application form are exact to the best of my knowledge.</i>
<i>Any false statement may lead sanctions under LQE. Any information provides will be an integral part of the purpose and will be published on the website of Evaluating Committee (COMEV) or Kativik environmental quality commission (CQEK) and Environmental Assessment Registry</i>
First name and family name
Eric Lewis
Signature

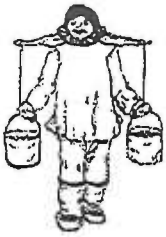
Date
29/01/2020



Northern Village of Puvirnituq
>A's'> >A's'>
P.O. Box 150
Puvirnituq, Quebec
J0M 1P0
Tel: (819) 988-2825
Fax: (819) 988-2751

Resolution No. 20-01-09

Concerning the approval of a Development Permit for FCNQ Quarry

- Whereas** in accordance with subsection 176 (1) of *An Act respecting Northern villages and the Kativik Regional Government* (CQLR, c. V-6.1; hereinafter the Kativik Act), the Municipal Council may adopt a by-law for the making of a master plan for the municipal territory, specifying the purposes for which each portion of the territory included in the plan may be used, and to enact that such a master plan become obligatory;
- Whereas** in accordance with section 167 of the Kativik Act, the Council may provide for the issuing of permits or certificates in relation to the application of a by-law contemplated in section 176 of the Kativik Act;
- Whereas** section 4.1 of *By-law No. 2007-03 concerning the adoption of the modified master plan for the municipal territory* provides that any project concerning land use or the use of a building shall be submitted beforehand to the Council so it can study the project;
- Whereas** section 4.3 of *By-law No. 2007-03 concerning the adoption of the modified master plan for the municipal territory* provides that the Council shall study such plans and then accept or refuse the plans by resolution;
- Whereas** this resolution shall serve as certificate if the project is approved;
- Whereas** the Federation des cooperatives du nouveau Quebec (FCNQ) had submitted an application for a Development Permit, a copy of which is appended as an integral part of this resolution, to request the authorization to open a Quarry on the location illustrated on the appended map;
- Whereas** the Council has reviewed the appended document and agrees with its content.

It is therefore resolved that:

1. the preamble be an integral part of this resolution;
2. the appended Development Permit request be approved;
3. the Secretary-Treasurer be authorized to sign any and all document required to implement this resolution;
4. a certified copy of this resolution be sent to FCNQ.
5. this resolution come into effect the day of its adoption.

Moved by: _____ Aipilie Kenuajuak
 Seconded by: _____ Simon Novalinga
 In favor: _____ 5 Abstentions: _____ 0
 Opposed: _____ 0 Absentees: _____ 2
 Date of adoption: _____ January 22, 2020
 Mayor's signature: _____
 Sec.-Treasurer's signature: _____



Handwritten: Certified true Copy Jan. 24/20.



Appendix III

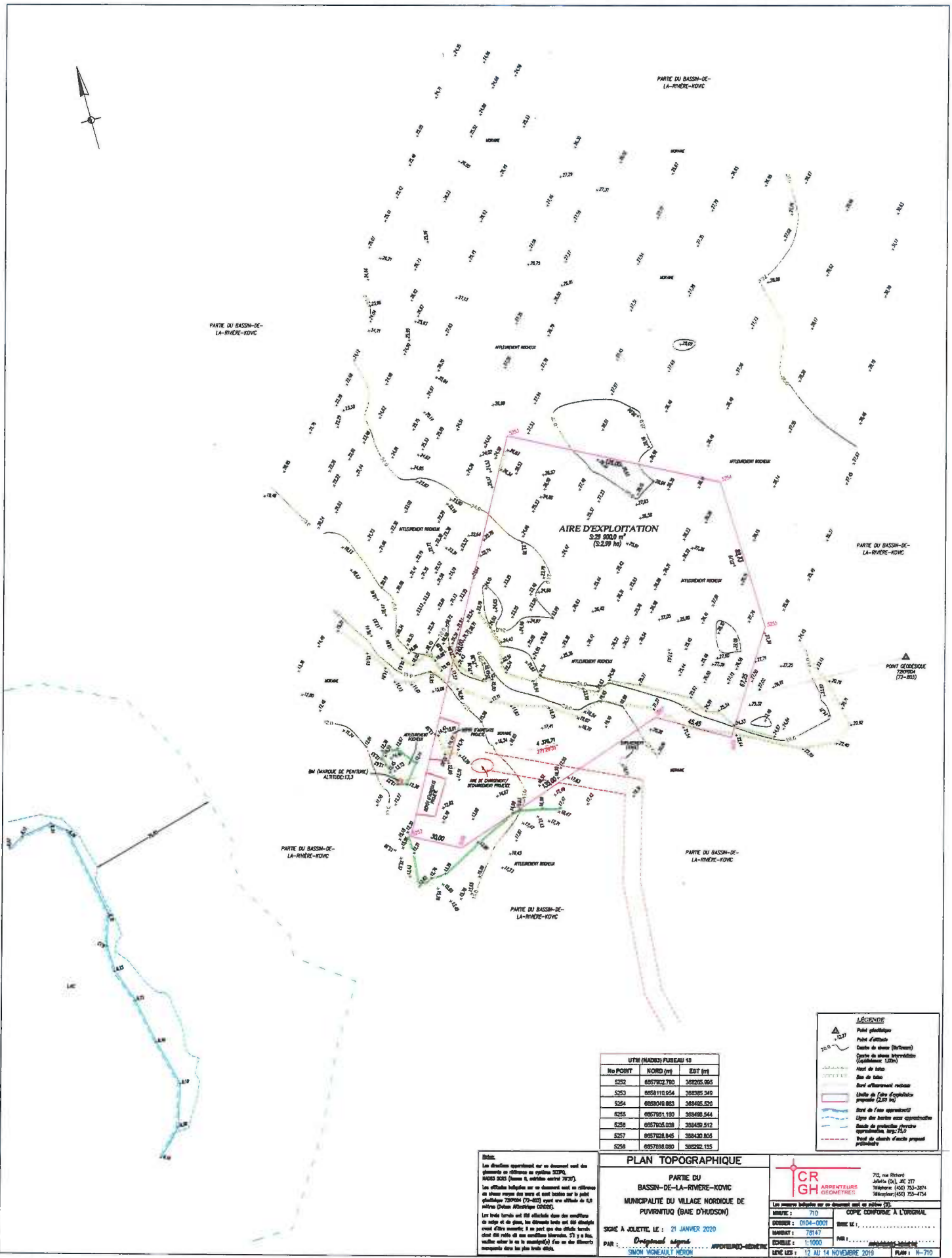

LÉGENDE

- ▲ Point géodésique
- Point d'altitude
- Contour de niveau (Métrisme)
- Contour de niveau Métrisme (Légende: 1:20)
- Contour de niveau
- Contour d'assèchement existant
- Contour de ligne d'exploitation proposée (2,50 ha)
- Aire de l'eau appropriée
- Ligne de limite avec appropriation
- Aire de production d'eau appropriée, 100% / 100
- Aire de culture d'été proposée

UTM (NAD83) BUREAU 18

No POINT	NORD (m)	EST (m)
5292	695792,790	388295,895
5293	6958110,654	388385,549
5294	6958048,883	388485,520
5295	6957991,180	388480,544
5296	6957905,038	388480,512
5297	6957928,845	388480,805
5298	6957988,090	388292,135

Notes:
 Les données géométriques sur ce document sont des données en référence au système SRS95 NAD83 (Zone 18, métrisme en UTM).
 Les altitudes indiquées sur ce document sont en référence au datum moyen des mers et sont basées sur le point géodésique 720904 (72-80) ayant une altitude de 14,9 mètres (Datum Métrisme COGEO).
 Les traits bleus ne sont pas officiels et ne constituent pas de limites de propriété. Les limites bleues ne sont que des lignes orientées d'une manière à ne pas que des limites soient créées sans le consentement écrit de la personne concernée. Elles ne sont pas destinées à être utilisées pour des fins de médiation.

PLAN TOPOGRAPHIQUE
 PARTIE DU
 BASSIN-DE-LA-RIVIERE-KOVIC
 MUNICIPALITÉ DU VILLAGE NORDIQUE DE
 PUVIARTUQ (BAIE D'HUDSON)
 SIGNÉ A JOLLETTE, LE : 21 JANVIER 2020
 PAR : *Dominique Lévesque*
 SIMON VIGOREAU / MÉTRISME

CR GH
 ARRETEURS
 GEOMETRIE

712, rue Pélérin
 Joliette (QC, J6E 2T7)
 Téléphone: (450) 753-3874
 Télécopieur: (450) 753-4754

Les données géométriques sur ce document sont en référence au système SRS95 NAD83 (Zone 18, métrisme en UTM).
 COPIE CONFIRMÉE À L'ORIGINAL

MÉTRISME : 710
 SCHEMATA : 0104-0201
 SIGNÉ LE : 7/1/17
 ÉCHELLE : 1:1000
 LEVÉ LES : 12 AU 14 NOVEMBRE 2016
 PLAN : N-710